

NEW

The new safety shock absorber series SCS-300 to 650 are based on the innovative technology of the SC² series by ACE. By combining the piston and inner tube, an energy capacity up to 525 Nm can be achieved for emergency use. With the smaller thread sizes of M20x1.5 and M25x1.5 the successful SCS series from ACE is now completed.

Through the highest possible energy absorption capacity in this unique compact design, this versatile series of safety shock absorbers are suitable for a great variety of emergency uses, such as the smaller and faster linear drives being designed today and also presents:

- freedom from rebound forces
- increase in process reliability
- elimination of destructive forces
- prevention of expensive machine failures

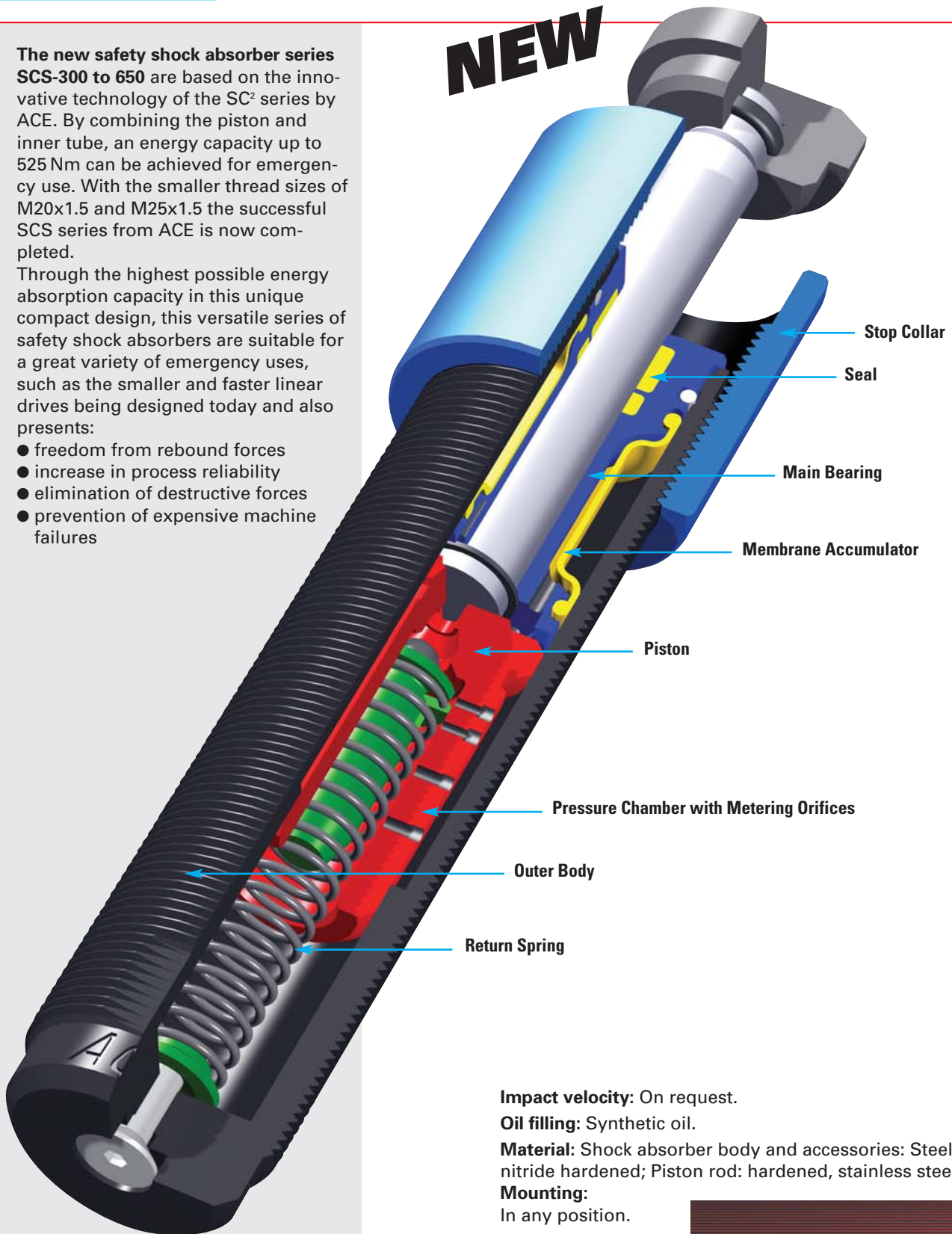

Impact velocity: On request.

Oil filling: Synthetic oil.

Material: Shock absorber body and accessories: Steel, nitride hardened; Piston rod: hardened, stainless steel.

Mounting:
In any position.

Operating temperature range:
0°C to 66°C.



NEW

Part Number SCS-300

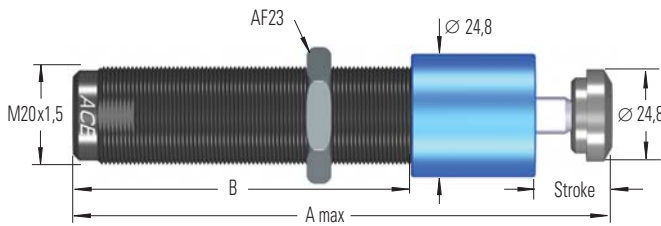

Standard dimensions

KM 20



Locknut
M20 x 1.5

MB 20 SC²

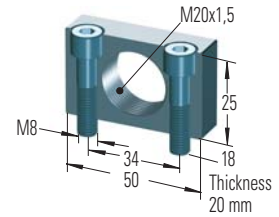

Mounting Block

Part Number SCS-650

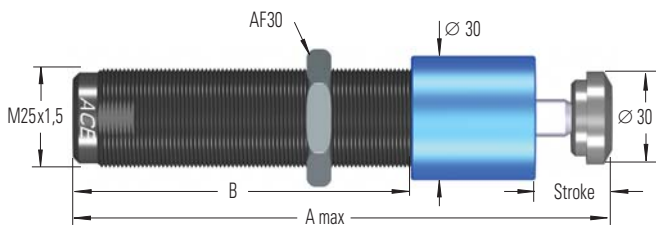

Standard dimensions

KM 25



Locknut
M25 x 1.5

MB 25 SC²

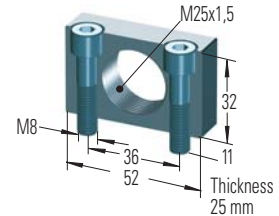

Mounting Block

Ordering Example

SCS-300-UKxxxx

Safety Shock Absorber →
 Size 300, Thread M20 →
 (Size 650, Thread M25) →
 Identification-No. assigned by ACE →

Complete Details Required when Ordering:

Moving Load	m	(kg)
Emergency Impact Speed	v	(m/s) max.
Normal Speed	vs	(m/s) max.
Motor Power	P	(kW)
Stall Torque Factor	ST	(normal 2.5)
Number of Absorbers in Parallel	n	

or technical data according to formulae and calculations on page 13 to 15.

Technical Data

Energy capacity W_3 : at max. side load angle do not exceed 80 % of rated max. energy capacity below.

Return force: 8 to 33 N.

Operating temperature range: 0°C to 66°C.

Impact cycles per hour: Emergency use only.

Calculation: For further details of calculation and selection please consult ACE.

The calculation and selection of the correct ACE Safety Shock Absorber for your application should be referred to ACE for approval and assignment of unique identification number.

Dimensions and Capacity Chart

Type	Stroke mm	A max.	B	Max. Energy Capacity per Cycle		Max. Side Load Angle	Weight kg
				Standard W_3 max. Nm	Optimised Version W_3 max. Nm		
SCS-300	15	105.5	66.5	292	365	2	0.175
SCS-650	23	140	86	420	525	2	0.35