

G-50 SERIES

Patented

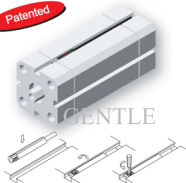

DIMENSION

G-50N, G-50P, G-50D / G-50N-QD, G-50P-QD, G-50D-QD



G-50R, G-50R-QD / G-50RP, G-50RP-QD

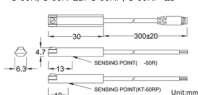

QD PINOUT

*3 wire QD wiring



*2 wire QD wiring



*2 wire EQD wiring



SPECIFICATION

TYPE	G-50R	G-50D	G-50N	G-50P	G-50RP
CONNECT DIAGRAM					
CHARACTERISTICS					
WIRING METHOD	2-Wire Type			3-Wire Type	
SWITCHING LOGIC	SPST Normally Open	Solid State Output, Normally Open			SPST, Normally Open
SENSOR TYPE	Reed Switch	—	NPN Current Sinking	PNP Current Sourcing	Reed Switch
OPERATING VOLTAGE	5~240V DC/AC	10~28V DC	10~30V DC		
SWITCHING CURRENT	100mA max.	50 mA max.	200mA max.	6W max.	500mA max.
CONTACT RATING	10W max.	1.5W max.	20mA @ 24VDC max.	6W max.	10W max.
CURRENT CONSUMPTION	—	—	20mA @ 24VDC max.	—	5mA @ 24V DC max.
VOLTAGE DROP	3.0V max.	3.5V max.	1.5V max.	—	0.1V @ 100mA max.
LEAKAGE CURRENT	—	0.8 mA max.	0.05 mA max.	—	—
INDICATOR	—	Red LED	—	—	Yellow LED
CABLE	φ3, 2C, PU			φ3, 3C, PU	
OPERATING FREQUENCY	200 Hz	—	1000 Hz	—	200 Hz
MAGNET REQUIREMENT(NOTE 1.)	40 Gauss			—	
TEMPERATURE RANGE	-10~70 °C			—	
SHOCK (NOTE 2.)	30 G	—	50 G	—	30 G
VIBRATION (NOTE 3.)	9 G			—	
ENCLOSURE CLASSIFICATION	IEC 529 IP 67			—	
PROTECTION CIRCUIT	None	short-circuit	Reverse Polarity, short-circuit	None	

NOTE : 1.Measuring standard target : φ15.5×φ8×5t (Anisotropy Rubber Magnet)

2. Sin Wave / X - Y - Z 3 Directions / 3 Times Each Direction / 11ms Each Time.

3. Double Amplitude 1.5mm / 10Hz~55Hz~10Hz (Sweep 1min) / X - Y - Z 3 Directions / 1 Hour Each Time.

GROOVE DIMENSION

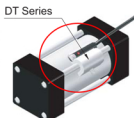
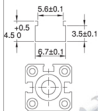

Unit:mm

GENTLE AUTOMATIC SOLUTION SDN BHD (684637-1)

No.36, Jalan Industri USJ 1/13, Taman Perindustrian USJ 1, 47600 Subang Jaya, Selangor, Malaysia
Tel: 603-8023 7743 / 8743 Fax: 603-8023 9743 http://www.gentle.com.my email: sales@gentle.com.my